

HOW TO OPERATE PHOENIX REDL2 ?

1. How to open ?

- Hold the upper round part and press the opening mark with thumb and lift it up leftward to open, and load batteries. (1.5V AAA Alkaline 4 pcs) Then, LED flickers with Bi Bi Bi sound.

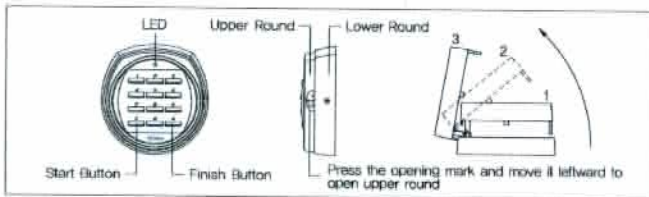

- The initial code from the factory is ①②③④.

- Step 1 : Push **C** button (LED flickers with Bi sound)
- Step 2 : Push the Code buttons (LED flickers with Bi sound)
- Step 3 : Push **#** button (LED flickers on with melodic tone)
- Step 4 : Turn knob (or handle) clockwise and open the door while melody rings (3 seconds).

- Note : ① In case that wrong code is tried, it sounds Bi Bi Bi Bi.
- ② If wrong codes are tried over 5 times, the lock gets paralysed and doesn't work.

How to release the lock from paralysis ?

- Enter the original code twice consecutively as in the opening procedure. (No sound but LED flickers when each button pushed. If the procedures are completed exactly, the lock recovers with melodic tone).

EX) **C**①②③④**#** **C**①②③④**#** (LED on, Melodic tone)

2. How to enter your personal code ?

Door must be open to change lock code(s).

★ 1st Code in Door opened, M - New Code -

- Step 1 : Push Memory button **M** on the door back. (LED flickers on with Bi sound)
- Step 2 : Push New Code buttons (4 digits min to 16 digits max, LED flickers on with Bi sound)
- Step 3 : Push **#** button (Melodic tone)

EX) If a new code is decided 2 1 0 0, push buttons as below.
M②①①①**#** (Melodic tone)

★ 2nd Code (A) in Door opened, M - 2 - # - New Code -

(A) Second code not required for lock to function, but is available for multi-users when desired.

- Step 1 : Push Memory button **M** on the door back. (LED flickers on with Bi sound)
- Step 2 : Push **2** button (LED flickers on with Bi sound)
- Step 3 : Push **#** button (LED flickers on with Bi — sound)
- Step 4 : Push 2nd New Code buttons (4 digits min to 16 digits max, LED flickers on with Bi sound)
- Step 5 : Push **#** button (Melodic tone)

EX) If a new code is decided 4 4 0 0, push buttons as follows.
M②**#**④④①①**#** (Melodic tone)

▲ Caution : To confirm if the code is exactly entered, push the code in opening procedures prior to closing door.

For example, in case of your code 4 4 0 0, push button **C**④④①①**#**. If the procedure is properly done, melody rings for three seconds.

★ How to erase the 2nd code? (Door opened, M - # - 2 - #)

- Step 1 : Push **M** button on the door back (LED flickers on with Bi sound)
- Step 2 : Push **#** button (Bi sound)
- Step 3 : Push **2** button (LED flickers with Bi sound)
- Step 4 : Push **#** button (Bi — sound)

3. When to replace batteries ?

If door is not opened in spite of exact code entered (LED flickers with sound and melodic tone), it indicates that battery is not strong enough to actuate the solenoid. Then, four batteries should be replaced all together with new ones. (1.5V AAA Alkaline 4 pcs)

- The personal code is not erased even if battery is completely exhausted.
- Battery life span : 1 year (In case of three door openings a day)